

## Biomass cooking carbon monoxide levels in commercial canteens in Kigali, Rwanda

Woolley, Katherine; Bartington, Suzanne; Pope, Francis; Price, Malcolm; Thomas, G Neil; Kabera, Telesphore

DOI:

[10.1080/19338244.2020.1761279](https://doi.org/10.1080/19338244.2020.1761279)

License:

Other (please specify with Rights Statement)

*Document Version*

Peer reviewed version

*Citation for published version (Harvard):*

Woolley, K, Bartington, S, Pope, F, Price, M, Thomas, GN & Kabera, T 2020, 'Biomass cooking carbon monoxide levels in commercial canteens in Kigali, Rwanda', *Archives of Environmental and Occupational Health*. <https://doi.org/10.1080/19338244.2020.1761279>

[Link to publication on Research at Birmingham portal](#)

### **Publisher Rights Statement:**

This is an Accepted Manuscript of an article published by Taylor & Francis in *Archives of Environmental and Occupational Health* on 13/05/2020, available online: <http://www.tandfonline.com/10.1080/19338244.2020.1761279>

### **General rights**

Unless a licence is specified above, all rights (including copyright and moral rights) in this document are retained by the authors and/or the copyright holders. The express permission of the copyright holder must be obtained for any use of this material other than for purposes permitted by law.

- Users may freely distribute the URL that is used to identify this publication.
- Users may download and/or print one copy of the publication from the University of Birmingham research portal for the purpose of private study or non-commercial research.
- User may use extracts from the document in line with the concept of 'fair dealing' under the Copyright, Designs and Patents Act 1988 (?)
- Users may not further distribute the material nor use it for the purposes of commercial gain.

Where a licence is displayed above, please note the terms and conditions of the licence govern your use of this document.

When citing, please reference the published version.

### **Take down policy**

While the University of Birmingham exercises care and attention in making items available there are rare occasions when an item has been uploaded in error or has been deemed to be commercially or otherwise sensitive.

If you believe that this is the case for this document, please contact [UBIRA@lists.bham.ac.uk](mailto:UBIRA@lists.bham.ac.uk) providing details and we will remove access to the work immediately and investigate.

## **Biomass cooking carbon monoxide levels in commercial canteens in Kigali, Rwanda**

Authors:

Katherine Woolley, Institute of Applied Health Research, University of Birmingham,  
Birmingham, UK, Email: [KEW863@student.bham.ac.uk](mailto:KEW863@student.bham.ac.uk) ORCID: 0000-0003-3743-9925

Suzanne E. Bartington, Institute of Applied Health Research, University of Birmingham,  
Birmingham, UK, Email: [s.bartington@bham.ac.uk](mailto:s.bartington@bham.ac.uk)

Francis D. Pope, School of Geography, Earth and Environmental Sciences, University of  
Birmingham, Birmingham, UK, Email: [F.Pope@bham.ac.uk](mailto:F.Pope@bham.ac.uk)

Malcolm J. Price, Institute of Applied Health Research, University of Birmingham,  
Birmingham, UK, Email: [M.Price.2@bham.ac.uk](mailto:M.Price.2@bham.ac.uk)

G. Neil Thomas, Institute of Applied Health Research, University of Birmingham,  
Birmingham, UK, Email: [G.N.Thomas@bham.ac.uk](mailto:G.N.Thomas@bham.ac.uk)

Telesphore Kabera, College of Science and Technology, University of Rwanda, Kigali,  
Rwanda Email: [kaberacris@yahoo.fr](mailto:kaberacris@yahoo.fr)

Corresponding Author: Katherine Woolley, Institute of Applied Health Research,  
University of Birmingham, Birmingham, UK,

Email: [KEW863@student.bham.ac.uk](mailto:KEW863@student.bham.ac.uk) Tel: + 44 (0) 7741463305

## **Abstract**

Carbon monoxide (CO) is harmful to human health, yet there is limited evidence concerning emissions associated with biomass fuel cooking in occupational settings.

Real-time 48-hour monitoring of CO concentrations at breathing height, was undertaken in staff and student kitchen and serving areas of two commercial canteens. We characterised two diurnal CO peaks coinciding with cooking activities. Peak CO concentrations of 255.5 ppm and 1-hour average of 76.3 ppm (IQR: 57.8–109.0 ppm) were observed in the student kitchen; the staff kitchen levels were 208.5 ppm, and 76.3 ppm (IQR: 52.5–114.0 ppm), respectively. High magnitude CO concentrations (8-hour average: 40.7 ppm SD: 40.0 ppm) which exceed World Health Organisation (WHO) Indoor Air Quality standards were observed. Further investigation of personal exposure and health impacts among kitchen staff are required, to inform interventions in this setting.

**Word count:** 2719

**Key Words:** Indoor air pollution; Carbon monoxide; Charcoal; Biomass; Commercial canteens; Occupational exposure

## INTRODUCTION

Wood, dung, agricultural residues, charcoal and coal,<sup>1,2</sup> are used by 3 billion people worldwide<sup>3-8</sup> as a primary source of cooking fuel.<sup>9,10</sup> Typically, these biomass fuels are relatively inexpensive and readily available,<sup>11-13</sup> with the highest usage in Low and Middle Income Countries (LMICs).<sup>14</sup> Rwanda is a rapidly developing country with a Gross Domestic Product (GDP) per capita of \$748.3 in 2017<sup>15</sup> and a high prevalence of biomass fuel usage, presenting long-term health, environmental and economic issues. Incomplete biomass combustion in poorly ventilated settings<sup>2,16</sup> produces carbon monoxide (CO), a colourless and odourless gas<sup>17</sup> which reduces blood oxygen-carrying capacity causing tissue hypoxia<sup>18</sup> and oxidative stress.<sup>19</sup> In addition, biomass fuel collection and production contributes to increased carbon emissions, deforestation and environmental degradation,<sup>20</sup> increasing, for example, the risk of land and mudslides hilly terrain around the capital Kigali.<sup>21</sup>

University canteen environments, as an exemplar of commercial kitchens in other settings, present potential prolonged Household Air Pollution (HAP) exposure risk to staff and students who use them on a daily basis. Multiple stove use increases both the intensity and magnitude of emissions. There remains a paucity of evidence of exposure assessment in LMIC occupational kitchen settings; with an existing research focus on domestic rather than industrial cooking emissions, even though restaurants, hotels and schools typically rely upon traditional large cooking stoves<sup>22</sup>.

In the UK, EU Indicative Occupational Exposure Limit Values (IOELVs) legislation defines CO Workplace Exposure Limits of 30 ppm (35 mg/m<sup>3</sup>) as an 8-hour Time Weighted Average (TWA) and short-term exposure limit 200 ppm (232 mg/m<sup>3</sup>).<sup>23</sup> However, the World Health Organisation (WHO) Indoor Air quality (IAQ) guidelines for a domestic setting has a TWA limit value of 6.1 ppm (7 mg/m<sup>3</sup>) for 24 hours, 8.7 ppm (10 mg/m<sup>3</sup>) for 8 hours, 30.6 ppm (35

mg/m<sup>3</sup>) for 1 hour and 87.3 ppm (100 mg/m<sup>3</sup>) for 15 minutes of exposure.<sup>24</sup> These levels along with short-term exposures of a magnitude (>200 ppm) are recognised to be seriously hazardous to human health. Exposure-response studies have shown acute and chronic health events<sup>18</sup> as a result of oxidative stress from CO exposure above threshold values, which include exacerbation of symptoms of myocardial ischaemia,<sup>18</sup> increased blood pressure<sup>25</sup> and adverse pregnancy outcomes<sup>26</sup> including low birth weight,<sup>26</sup> as a result of chronic hypoxia of the placenta from biomass smoke exposure in pregnancy,<sup>27</sup> and can be fatal at extreme concentrations.<sup>18</sup>

This study aimed to characterise patterns of CO emissions associated with charcoal fuel cooking in; (i) the kitchen, and (ii) the serving area, of two commercial canteens (staff/student) in a tertiary educational setting in Kigali, Rwanda.

## **MATERIALS AND METHODS**

### **Setting**

This observational study was conducted in the solid brick buildings of the staff and student canteens at the Nyarugenge Campus, University of Rwanda College of Science and Technology (UR-CST) (Figure 1). Each kitchen provides morning tea, lunch and dinner, with stoves being lit at 05:30 and 07:00 in the student and staff kitchens, respectively and main cooking sessions between 8:30-11:30 and 16:00-19:00. Morning tea involves brewing tea with milk and sugar. Lunch, the main meal of the day, and dinner consists mainly of beans, plantain, isombe (spinach, aubergine and cassava), umutsima (corn) and vegetables. A total of 18 staff work in the student kitchens and 5 in the staff kitchen, on a rotating shift basis, with 11 hour average shift duration. A total of 550 staff and students are catered for by the two kitchens each day, with the majority consuming their meals in a covered serving area. All

study fieldwork was conducted in January 2019, at the end of the wet season, with the occasional rain shower in the afternoon and ambient temperatures of 18–29 °C.

The student kitchen was set up for mass catering with six large fixed wood fuel stoves, each with a diameter of 1 metre. Above each stove, on the wall behind, is a small opening window (0.5 m x 0.5 m) and ventilation bricks at a height of 2 m (Figure 2), with no other structural or mechanical methods of ventilation. The kitchen is directly adjacent to the canteen serving area, situated in the corner of the hall. The seating area was situated in the opposite corner to the serving area, with open, vented windows situated along one side opposite the kitchen.

The staff kitchen area comprises of large portable charcoal stoves for cooking, in one enclosed room, with an open door leading into an enclosed courtyard (Figure 3). The two ends of the charcoal kitchen are constructed of two-thirds wall, and one-third wire fencing. The staff kitchen, also contained three gas cooking rings, located in an adjacent room. The kitchen connects to the staff canteen via stairs, leading upwards to a well-ventilated serving area with adjacent open balcony. The canteen dining area is an open plan area, along with a covered balcony.

## **Data Collection**

### **Carbon Monoxide**

Real-time CO concentration measurements were taken at 1-minute intervals for a 48-hour duration using electrochemical EasyLog EL-USB-CO Carbon Monoxide Data loggers (Lascar Electronics Ltd, Erie, PA), with an accuracy of  $\pm 7$ ppm and lower Limit of Detection (LOD) of 3 ppm; and a temperature range of -10 to +40°C. Monitoring was performed at a fixed location in each setting. In the student and staff kitchens, monitors were located at a respirable height of 150 cm and distance of 100-150 cm from the main cooking stove. The monitors in the canteen were positioned at the serving desk, as this being a common area is visited by

staff and students, positioned at a vertical height of 100-150 cm (respirable height). All monitoring commenced at 18:00 on a weekday and was performed at 1-minute intervals for a continuous period of 48 hours (Wednesday to Friday evening), therefore capturing two full days of cooking activities. CO levels below the lower LOD were assigned a value of 1.5 ppm (one half the lower LOD). Data were downloaded using EasyLog USB software (Lascar Electronics Ltd) to a text file for data cleaning prior to statistical analyses. Instrument calibration was undertaken by the manufacturer with accompanying laboratory calibration certificate.

### Kitchen characteristics

Kitchen characteristics were observed and recorded by local trained fieldworkers (final year undergraduate students at the University of Rwanda), including location of windows, doors and vents and number of stoves. Information on cooking characteristics, including timing of stove lighting and details of meal preparation was collected verbally from catering staff and by observation during daily fieldwork visits.

### Statistical analysis

We calculated descriptive statistics for average (arithmetic mean, geometric mean, median) and peak CO concentrations in each monitoring location, with real-time concentrations averaged over the total sampling and 8-hour and 11-hour shift durations respectively. With two 11-hour periods being assigned to cover the main working hours (06:00-17:00 and 09:00-22:00). All statistical analyses were performed in Stata v15,<sup>28</sup> including descriptive statistics and time-series analyses to identify peak and average (mean and median) CO concentrations. 8-hour time weighted averages (TWA) were calculated as the average of all data points (1-minute intervals) for the specified 8-hour time frame. Pearson's correlation was used to measure the association between CO concentrations in the kitchen and serving area. A Man-

Whitney U test was used to compare CO concentration between hourly average and shifts averages within each sampling area.

#### Ethical approval

Ethical approval for this study was gained through the University of Rwanda, approval number: No 317/CMHS IRB/2017.

## RESULTS

### Variation in CO across 48 hours

#### Student Kitchen and Canteen

CO levels in the student kitchen were observed to increase rapidly at 06:00 (Figure 4), coinciding with initial morning stove lighting. Figure 4 shows two distinct daily periods of high CO levels between 08:00–16:00 and 16:00–23:00 respectively, depicting the two main cooking periods. Each peak is characterised by a rapid increase in CO concentration, followed by a gradual decline, with levels remaining elevated above precooking levels between cooking events. The highest CO value was recorded on Friday at 11:00 with a 1-minute value concentration of 255.5 ppm, with the lowest background concentration of 1.5 ppm during nocturnal hours. We observed a large variation in CO levels across 48-hours, with a median value of 13 ppm (IQR: 3.5–40.0 ppm) (Table 1). CO concentrations at the student canteen serving area, were moderately associated with concentrations in the kitchen area ( $r = 0.38$ ,  $p < 0.001$ ), but at lower average levels, with peak 1-minute concentration of 41.5 ppm observed at 19:53.

#### Staff Kitchen and Canteen

Figure 5 shows CO concentrations increasing from 08:00 with highest recorded concentration 208.5 ppm between 09:00–10:00. CO levels decreased from late morning, with a second



smaller evening peak occurring at around 19:00. The average (median) 48-hour staff kitchen was 1.5 ppm (IQR: 1.5–18 ppm) (Table 1), which is below the lower LOD. Peak staff canteen serving area magnitude was 15 ppm, with levels increasing during cooking periods (09:00–13:00).

### **Average hourly concentration**

#### **Student Kitchen and Canteen**

Due to observed daily variations in CO levels, hourly average (median) values provide a more accurate indication of continuous personal concentration levels. Nocturnal levels are lower than daytime average concentrations ( $p < 0.001$ ), below the lower LOD at 1.5 ppm for four hours overnight (Appendix 1). The peak hourly average concentration 76.3 ppm (IQR: 57.8–109 ppm), occurs at 10:00–11:00, with a large increase from 09:00 (22.8 ppm, IQR: 18–29 ppm) and remaining elevated until midday (67.5 ppm, IQR: 53.3–83.3 ppm) (Figure 6). The evening peak occurs at 18:00–19:00 (61.3 ppm, IQR: 42–77.8 ppm). Corresponding peak 1-hour averages occur in the student canteen at 10:00–11:00 (CO: 6.3 ppm IQR: 4–8 ppm) and 17:00–18:00 (CO: 1.8 ppm IQR: 0–3 ppm), correlating with temporal changes in kitchen concentrations. However, these peak 1-hour average concentrations are not significantly different to the hour before or after, apart from the student canteen 10:00–11:00 ( $U = 5.3$ ,  $p < 0.001$ ) and 17:00–18:00 ( $U = -7.4$ ,  $p < 0.001$ ).

#### **Staff Kitchen and Canteen**

The staff kitchen has the highest 1-hour average at 09:00–10:00 (76.3 ppm, IQR: 52.5–114 ppm - Figure 7) ( $U = 3.7$ ,  $p < 0.001$ ), with a second non-significant peak of lower magnitude at 18:00–19:00 (15.3 ppm IQR: 1.5–30 ppm,  $U = -1.0$ ,  $p = 0.32$ ) and nocturnal concentration 1.5 ppm (Appendix 2). Average hourly concentrations in the staff canteen were 1.5 ppm.

### **Average 8-hour and 11-hour concentrations**

The greatest 8-hour average concentrations occurred during the first cooking periods (06:00–14:00) in both student (mean 40.7 ppm, SD: 40.0 ppm) and staff (mean 34.7 ppm, SD: 35.8 ppm) kitchens respectively (Table 2). However, the first shift in the student kitchen was not significantly different from the afternoon shift ( $U=-1.7$ ,  $p=0.08$ ). The highest mean 8-hour concentration for the serving area was recorded in the student serving area during the afternoon shift at a concentration of 7 ppm (SD: 8.2 ppm), but was not significantly different from the morning shift ( $U=1.5$ ,  $p=0.14$ ). In comparison, the greatest 11-hour average (Table 2) concentration occur in between 09:00-22:00 in the student kitchen (mean 43.5 ppm, SD: 35.4 ppm) and 06:00-17:00 in the staff kitchen (mean 25.0 ppm, SD: 29.9 ppm). The student serving area held the greatest 11-hour average concentration between 09:00-22:00 (mean 5.9 ppm, SD: 6.6 ppm). An 11-hour limit level was calculated from the WHO IAQ limit levels, at 8.2 ppm (9.4 mg/m<sup>3</sup>).

## **DISCUSSION**

To the best of our knowledge, this is the first study to obtain primary pollutant measurements in a commercial catering setting in Rwanda, where biomass fuel combustion represents over 85% of overall energy consumption.<sup>29</sup> Although high CO levels (TWA range of 4.9–50 ppm) have previously been reported within domestic settings in sub-Saharan Africa,<sup>30–33</sup> our findings suggest workplace CO concentrations are of a greater peak intensity and longer duration. Peak kitchen concentrations during lunch (Student = 255.5 ppm and Staff = 208.5 ppm) and dinner (Student = 170.0 ppm and Staff = 74.5 ppm) cooking sessions, with the calculated 8-hour average exceeding the WHO domestic IAQ 8-hour time-weighted average (TWA) limit values which emphasises the concentrations are hazardous for human health.

Through use of real-time monitoring we identified two characteristic diurnal CO peaks coinciding with cooking activities, consistent with temporal patterns reported in domestic

biomass fuel settings.<sup>34–37</sup> Peaks are characterised by a rapid increase in CO emissions coinciding with stove lighting and cooking onset,<sup>38</sup> followed by gradual decline and plateau above background values for several hours after the main cooking periods (Figures 4 and 5). In the student kitchen nocturnal CO levels remained elevated above background values, at a range of 1.5–30.5 ppm. These high-intensity, prolonged duration pollutant episodes differ from temporal patterns reported previously in domestic settings which are typically characterised by short intensity peaks.<sup>3,39,40</sup> However, to the best of our knowledge, there are no previous time-series investigations of CO levels associated with wood and charcoal stoves in occupational environments, therefore limiting detailed comparisons. Indicative differences may reflect cooking period and quantity and number of stoves deployed in a commercial canteen environment in comparison to single meal preparation in a domestic kitchen. The observed increase in CO levels at the end of cooking sessions in our study may reflect extinguishing the stoves<sup>3,39,41</sup>. Temporal and spatial differences may be attributable to fuel moisture content, fuel density or ventilation<sup>34,38,42,43</sup>, therefore further detailed investigation of the relative contribution of these factors is merited in this setting.

8-hour average CO levels observed in canteen serving areas used by both university staff (1.6 ppm SD: 0.7 ppm) and students (4.4 ppm SD: 5.4 ppm), were lower than respective kitchen concentrations and did not exceed WHO 8-hour IAQ limit values, reflecting increased distance from the pollutant source, creating greater dispersion.<sup>44</sup> The main difference in the level of ventilation between the two areas was the opportunity for circulating airflow through the entrance and balcony doors in the staff serving area and that the staff serving area was not directly connected to the kitchen, being separated by a stairway. However, concentrations in the student serving area were elevated above background levels and the high number of students attending for meals suggests a potentially greater population exposure level among

this group compared to university staff; although the health effects, if any, at this level of exposure are unclear.

Exposure comparisons between studies is difficult due to varying micro environments, differing sampling strategies, including position, duration and calibration of monitoring devices.<sup>45</sup> There are some limitations to our work. Our observations were obtained by monitoring sessions of 48-hour duration in each study location but we did not attempt to account for variability in weather conditions or ventilation; therefore no dispersion modelling<sup>46</sup> could be undertaken. Although a 48 hour assessment of diurnal variation is relatively short in duration, it highlights regular periods in exceedance of the WHO guideline values, within a commercial biomass burning canteen setting. However, alternative sources of CO emissions were not investigated, but the kitchen and canteen settings were away from major roads and there were no electricity generators in close proximity to the study location suggesting these potential influences were of minimal relevance in this setting. Smoking prevalence is low in Rwanda, with a 4.7 % smoking prevalence in 15–49 year olds;<sup>47</sup> and therefore was not considered as a major source in this context.

Absolute individual exposure cannot be inferred from this study, which is required to estimate the potential health harms, as we did not perform personal monitoring of staff which may yield different results to fixed site measurements.<sup>48</sup> However the monitoring location (1 m height, 1.5 m distance from the stove) was selected to represent typical breathing height during cooking and serving tasks. Further investigation of personal exposure assessment among catering staff, including investigation of health and cognitive symptoms would provide more detailed understanding of the occupational risks of biomass fuel cooking in this setting.

Our findings indicate the need for effective and sustainable harm reduction strategies in catering environments using charcoal or wood fuel, such as through structural or behavioural

modification or transition to a cleaner energy source (e.g. LPG). Transition would require financial investment and staff training and cultural acceptability, for instance, to address potential changes in food taste and logistical considerations for safe storage and usage.

## **CONCLUSION**

Our findings indicate that charcoal and wood fuel combustion in this commercial catering setting in Rwanda was associated with 8-hour average kitchen CO concentrations which exceed WHO 8-hour IAQ guidelines and are of a hazardous level for human health. Further investigation of personal exposures and health impacts among catering staff would improve the evidence base concerning occupational exposure risks in this setting.

### **Acknowledgements**

We are grateful to Dr Ignace Gatere, Principal of the University of Rwanda College of Science and Technology and all canteen and catering staff for their assistance with this study. In addition, to Pacifique Abimana, Patrick R Tumwizere and Clement Uwanyirigira, for their help in field observations.

### **Declaration of Interest statement**

The authors declare that they have no conflicts of interest

### **Funding**

KW is supported by a University of Birmingham Global Challenges PhD Studentship, providing financial support for project fieldwork. Monitoring equipment purchase and maintenance was supported by a University of Birmingham Wellcome Trust Institutional Strategic Support Fund (ISSF) award held by SEB.

### **Author Contributions**

SEB and TK were responsible for developing the study design and provided oversight for data analyses and interpretation. Primary data collection was undertaken by KW, SEB and TK. KW undertook data analysis and production of draft manuscript. SEB, FDP, GNT and KB provided advice for data collection, statistical analyses and data interpretation, along with commenting on the draft manuscript. MP provided advice on statistical analyses. All authors have read and approved the manuscript for publication.

## REFERENCES

1. Balakrishnan K, Parikh J, Sankar S, et al. Daily average exposures to respirable Particulate Matter from combustion of biomass fuels in rural households of southern India. *Environ Health Perspect.* 2002;110:1069-1075. doi:10.1289/ehp.021101069
2. Smith KR, Mehta S, Maeusezahl-Feuz M. Indoor air pollution from household use of solid fuels. In: Ezzati, M., Lopez, A.D., Rodgers, A.A. and Murray CJ, ed. *Comparative Quantification of Health Risk: Global and Regional Burden of Disease Attributable to Selected Major Risk Factors*. Geneva: World Health Organization; 2004:1435-1493. <https://www.who.int/publications/cra/chapters/volume2/1435-1494.pdf>. Accessed November 19, 2018.
3. Ezzati M, Kammen DM. The health impacts of exposure to indoor air pollution from solid fuels in developing countries: knowledge, gaps, and data needs. *Environ Health Perspect.* 2002;110(11):1057-1068. doi:10.1289/ehp.021101057
4. Smith KR, Mehta S. The burden of disease from indoor air pollution in developing countries: comparison of estimates. *Int J Hyg Environ Health.* 2003;206(4-5):279-289. doi:10.1078/1438-4639-00224
5. World Health Organization (WHO). *Opportunities for Transition to Clean Household Energy: Application of the WHO Household Energy Assessment Rapid Tool (HEART) in Ghana*. Geneva: World Health Organization; 2018.
6. World Health Organization (WHO). *Indoor Air Pollution from Solid Fuels and Risk of Low Birth Weight and Stillbirth: Report from a Symposium Held at the Annual Conference of the International Society for Environmental Epidemiology (ISEE)*. Johannesburg; 2005. [http://apps.who.int/iris/bitstream/handle/10665/43766/9789241505735\\_eng.pdf;jsessionid=1D7CA908821E66D221779F63DDDB323A?sequence=1](http://apps.who.int/iris/bitstream/handle/10665/43766/9789241505735_eng.pdf;jsessionid=1D7CA908821E66D221779F63DDDB323A?sequence=1). Accessed December 6, 2018.
7. Hosgood HD, Chapman R, Shen M, et al. Portable stove use is associated with lower lung cancer mortality risk in lifetime smoky coal users. *Br J Cancer.* 2008;99(11):1934-1939. doi:10.1038/sj.bjc.6604744

8. Kadir MM, McClure EM, Goudar SS, et al. Exposure of pregnant women to indoor air pollution: a study from nine low and middle income countries. *Acta Obstet Gynecol Scand.* 2010;89:540-548. doi:10.3109/00016340903473566
9. Arku RE, Birch A, Shupler M, Yusuf S, Hystad P, Brauer M. Characterizing exposure to household air pollution within the Prospective Urban Rural Epidemiology (PURE) study. *Environ Int.* 2018;114:307-317. doi:10.1016/j.envint.2018.02.033
10. Misra A, Longnecker MP, Dionisio KL, et al. Household fuel use and biomarkers of inflammation and respiratory illness among rural South African Women. *Environ Res.* 2018;166:112-116. doi:10.1016/j.envres.2018.05.016
11. Barría MRP. Indoor Air Pollution by Particulate Matter from Wood Fuel: An Unresolved Problem. *Environ Pollut Clim E Chang.* 2016;1. doi:10.4172/2573-458X.1000104
12. Benka-Coker ML, Tadele W, Milano A, Getaneh D, Stokes H. A case study of the ethanol CleanCook stove intervention and potential scale-up in Ethiopia. *Energy Sustain Dev.* 2018;46:53-64. doi:10.1016/j.esd.2018.06.009
13. Fullerton DG, Bruce N, Gordon SB. Indoor air pollution from biomass fuel smoke is a major health concern in the developing world. *Trans R Soc Trop Med Hyg.* 2008;102(9):843-851. doi:10.1016/j.trstmh.2008.05.028
14. Bruce N, Pope D, Rehfuess E, Balakrishnan K, Adair-Rohani H, Dora C. WHO indoor air quality guidelines on household fuel combustion: Strategy implications of new evidence on interventions and exposure–risk functions. *Atmos Environ.* 2015;106:451-457. doi:10.1016/j.atmosenv.2014.08.064
15. The World Bank. Rwanda | Data. <https://data.worldbank.org/country/rwanda>. Published 2018. Accessed November 26, 2018.
16. Smith KR, Samet JM, Romieu I, Bruce N. Indoor air pollution in developing countries and acute lower respiratory infections in children. *Thorax.* 2000;55(6):518-532. doi:10.1136/thorax.55.6.518
17. Public Health England. *Compendium of Chemical Hazards: Carbon Monoxide: General Information.* Gov.uk. UK; 2016. <https://www.gov.uk/government/publications/carbon-monoxide-properties-incident-management-and-toxicology>. Accessed January 30, 2019.
18. Kleinman MT. Carbon Monoxide. In: Lippmann M, ed. *Environmental Toxicants: Human Exposures and Their Health Effects.* Third Edit. Hoboken, New Jersey: John Wiley & Sons; 2009:455-486. [www.wiley.com](http://www.wiley.com). Accessed January 29, 2019.
19. Commodore AA, Zhang J, Chang Y, et al. Concentrations of urinary 8-Hydroxy-2'-deoxyguanosine and 8-isoprostane in women exposed to woodsmoke in a cookstove intervention study in San Marcos, Peru. *Env Int.* 2013;60:112-122. doi:10.1016/j.envint.2013.08.013
20. Hutton G, Rehfuess E, Tediosi F. Evaluation of the costs and benefits of interventions to reduce indoor air pollution. *Energy Sustain Dev.* 2007;11(4):34-43. doi:10.1016/S0973-0826(08)60408-1
21. Bizimana H, Sönmez O. Landslide Occurrences in The Hilly Areas of Rwanda, Their Causes and Protection Measures. *Disaster Sci Eng.* 2015;1:1-7.

- <http://www.disasterengineering.com/download/article-file/408168>. Accessed February 15, 2019.
22. Kshirsagar MP, Kalamkar VR. A comprehensive review on biomass cookstoves and a systematic approach for modern cookstove design. *Renew Sustain Energy Rev.* 2014;30:580-603. doi:10.1016/j.rser.2013.10.039
  23. Health and Safety Executive. *EH40/2005 Workplace Exposure Limits*. 3rd Editio. UK: TSO; 2018. <http://www.hse.gov.uk/pUbns/priced/eh40.pdf>. Accessed January 21, 2019.
  24. World Health Organization (WHO). *WHO Guidelines for Indoor Air Quality: Selected Pollutants*. Denmark; 2010. [www.euro.who.int](http://www.euro.who.int). Accessed February 18, 2019.
  25. Quinn AK, Bruce N, Puzzolo E, et al. An analysis of efforts to scale up clean household energy for cooking around the world. *Energy Sustain Dev.* 2018;46:1-10. doi:10.1016/j.esd.2018.06.011
  26. Salam MT, Millstein J, Li Y-F, Lurmann FW, Margolis HG, Gilliland FD. Birth outcomes and prenatal exposure to ozone, carbon monoxide, and particulate matter: results from the Children's Health Study. *Environ Health Perspect.* 2005;113(11):1638-1644. doi:10.1289/ehp.8111
  27. Dutta A, Khramtsova G, Brito K, et al. Household air pollution and chronic hypoxia in the placenta of pregnant Nigerian women: A randomized controlled ethanol Cookstove intervention. *Sci Total Environ.* 2018;619-620:212-220. doi:10.1016/j.scitotenv.2017.11.091
  28. StataCorp. Stata Statistical Software: Release 15. College Station, TX: StataCorp LLC; 2017.
  29. Nyamvumba R, Gakuba M. *Expression of Interest for Scaling up Renewable Energy Program (SREP) Financing for Energy Projects in Rwanda*. Rwanda; 2014. [https://www.climateinvestmentfunds.org/sites/cif\\_enc/files/meeting-documents/rwanda\\_eoi\\_0.pdf](https://www.climateinvestmentfunds.org/sites/cif_enc/files/meeting-documents/rwanda_eoi_0.pdf). Accessed March 25, 2019.
  30. Ochieng C, Vardoulakis S, Tonne C. Household air pollution following replacement of traditional open fire with an improved rocket type cookstove. *Sci Total Environ.* 2017;580:440-447. doi:10.1016/j.scitotenv.2016.10.233
  31. Wylie BJ, Kishashu Y, Matechi E, et al. Maternal exposure to carbon monoxide and fine particulate matter during pregnancy in an urban Tanzanian cohort. *Indoor Air.* 2017;27(1):136-146. doi:10.1111/ina.12289
  32. Yip F, Christensen B, Sircar K, et al. Assessment of traditional and improved stove use on household air pollution and personal exposures in rural western Kenya. *Environ Int.* 2017;99:185-191. doi:10.1016/j.envint.2016.11.015
  33. Kabera T, Bartington S, Uwanyirigira C, Abimana P, Pope F. Indoor PM 2.5 characteristics and CO concentration in households using biomass fuel in Kigali, Rwanda. *Int J Environ Stud.* 2020. doi:10.1080/00207233.2020.1732067
  34. Bartington SE, Bakolis I, Devakumar D, et al. Patterns of domestic exposure to carbon monoxide and particulate matter in households using biomass fuel in Janakpur, Nepal. *Environ Pollut.* 2017;220:38-45. doi:10.1016/j.envpol.2016.08.074



35. Kelp MM, Grieshop AP, Reynolds CCO, et al. Real-time indoor measurement of health and climate-relevant air pollution concentrations during a carbon-finance-approved cookstove intervention in rural India. *Dev Eng*. 2018;3:125-132. doi:10.1016/j.deveng.2018.05.001
36. Dutta K, Shields KN, Edwards R, Smith KR. Impact of improved biomass cookstoves on indoor air quality near Pune, India. *Energy Sustain Dev*. 2007;11(2):19-32. doi:10.1016/S0973-0826(08)60397-X
37. Dionisio KL, Howie S, Fornace KM, Chimah O, Adegbola RA, Ezzati M. Measuring the exposure of infants and children to indoor air pollution from biomass fuels in The Gambia. *Indoor Air*. 2008;18(4):317-327. doi:10.1111/j.1600-0668.2008.00533.x
38. Leavey A, Londeree J, Priyadarshini P, et al. Real-Time Particulate and CO Concentrations from Cookstoves in Rural Households in Udaipur, India. *Environ Sci Technol*. 2015;49(12):7423-7431. doi:10.1021/acs.est.5b02139
39. Ezzati M, Saleh H, Kammen DM. The contributions of emissions and spatial microenvironments to exposure to indoor air pollution from biomass combustion in Kenya. *Environ Health Perspect*. 2000;108(9):833-839. doi:10.1289/ehp.00108833
40. Ezzati M, Kammen. Indoor air pollution from biomass combustion and acute respiratory infections in Kenya: an exposure-response study. *Lancet*. 2001;358:619-624. doi:10.1016/s0140-6736(01)05777-4
41. Ezzati M, Kammen DM. Evaluating the health benefits of transitions in household energy technologies in Kenya. *Energy Policy*. 2002;30:815-826.
42. Das I, Pedit J, Handa S, Jagger P. Household air pollution (HAP), microenvironment and child health: Strategies for mitigating HAP exposure in urban Rwanda. *Environ Res Lett*. 2018;13:045011. doi:10.1088/1748-9326/aab047
43. Okello G, Devereux G, Semple S. Women and girls in resource poor countries experience much greater exposure to household air pollutants than men: Results from Uganda and Ethiopia. *Environ Int*. 2018;119:429-437. doi:10.1016/j.envint.2018.07.002
44. Hood E. Cooking catastrophe: chronic exposure to burning biomass. *Environ Health Perspect*. 2002;110(11):A691. doi:10.1289/ehp.110-a691
45. Gordon SB, Bruce NG, Grigg J, et al. Respiratory risks from household air pollution in low and middle income countries. *Lancet Respir Med*. 2014;2(10):823-860. doi:10.1016/S2213-2600(14)70168-7
46. Zhao K, Zhou X, Zhao B. Cooking generated particles' impact on indoor air quality of university cafeteria. *Build Simul*. 2010;3(1):15-23. doi:10.1007/s12273-010-0305-8
47. National Institute of Statistics of Rwanda (NISR), Ministry of Health (MOH), ICF International. Rwanda Demographic and Health Survey 2014- 15, District Profile Chart Book, City of Kigali. [www.statistics.gov.rw/file/1000/download?token=EvnjY6dO](http://www.statistics.gov.rw/file/1000/download?token=EvnjY6dO). Published 2016. Accessed November 19, 2018.
48. Steinle S, Reis S, Sabel CE. Quantifying human exposure to air pollution—Moving from static monitoring to spatio-temporally resolved personal exposure assessment. *Sci Total Environ*. 2013;443:184-193. doi:10.1016/j.scitotenv.2012.10.098

## APPENDICIES

Appendix 1: Descriptive statistics by place of measurement at each hour of the day in the student kitchen and serving area

Appendix 2: Descriptive statistics by place of measurement at each hour of the day in the staff serving area and kitchen

### Tables

|                      | <b>Number of observations</b> | <b>Arithmetic Mean (SD)</b> |        | <b>Geometric mean (SD)</b> |       | <b>Median (IQR)</b> |             | <b>Minimum</b> | <b>Maximum</b> |
|----------------------|-------------------------------|-----------------------------|--------|----------------------------|-------|---------------------|-------------|----------------|----------------|
| Student Kitchen      | 2880                          | 27.4                        | (34.0) | 11.8                       | (1.4) | 13.0                | (3.5, 40.0) | 1.5            | 255.5          |
| Student Serving area | 2880                          | 4.4                         | (5.4)  | 3.0                        | (0.8) | 3.0                 | (1.5, 4.5)  | 1.5            | 41.5           |
| Staff Serving area   | 2880                          | 1.6                         | (0.7)  | 1.5                        | (0.2) | 1.5                 | (1.5, 1.5)  | 1.5            | 15.0           |
| Staff Kitchen        | 2880                          | 15.1                        | (25.9) | 4.8                        | (1.5) | 1.5                 | (1.5, 18.0) | 1.5            | 208.5          |

Number of observation recorded by one monitor

Arithmetic Mean = Arithmetic Mean CO (ppm) concentration across 48 hours

Geometric Mean = Geometric Mean CO (ppm) concentration across 48 hours

SD = standard deviation of the mean

Median = Median CO (ppm) concentration across 48 hours

IQR = Interquartile range of concentrations across 48 hours

(Min, Max) = the minimum and Maximum CO (ppm) concentration across 48 hours

| <b>8 hour average</b>        |             |              |                             |             |  |  |
|------------------------------|-------------|--------------|-----------------------------|-------------|--|--|
| <b>Student Kitchen</b>       |             |              | <b>Student Serving Area</b> |             |  |  |
|                              | Mean (SD)   | (Min, Max)   | Mean (SD)                   | (Min, Max)  |  |  |
| 06:00 - 14:00                | 40.7 (40.0) | (1.5, 255.5) | 4.5 (2.2)                   | (1.5, 17.0) |  |  |
| 14:00 - 22:00                | 37.9 (31.5) | (3.0, 178.5) | 7.0 (8.2)                   | (1.5, 41.5) |  |  |
| 22:00 - 06:00                | 3.5 (3.6)   | (1.5, 30.5)  | 1.7 (0.6)                   | (1.5, 4.5)  |  |  |
| <b>Staff Kitchen</b>         |             |              | <b>Staff Serving Area</b>   |             |  |  |
|                              | Mean (SD)   | (Min, Max)   | Mean (SD)                   | (Min, Max)  |  |  |
| 06:00 - 14:00                | 34.7 (35.8) | (1.5, 208.5) | 1.7 (1.2)                   | (1.5, 15.0) |  |  |
| 14:00 - 22:00                | 9.2 (11.2)  | (1.5, 74.5)  | 1.5 (0.3)                   | (1.5, 8.0)  |  |  |
| 22:00 - 06:00                | 1.5 (0.1)   | (1.5, 3.5)   | 1.5 (0.0)                   | (1.5, 1.5)  |  |  |
| <b>11 hour shift average</b> |             |              |                             |             |  |  |
| <b>Student Kitchen</b>       |             |              | <b>Student Serving Area</b> |             |  |  |
|                              | Mean (SD)   | (Min, Max)   | Mean (SD)                   | (Min, Max)  |  |  |
| 06:00 – 17:00                | 38.0 (38.6) | (1.5, 205)   | 3.9 (2.4)                   | (1.5, 14.5) |  |  |
| 09:00 – 22:00                | 43.5 (35.4) | (1.5, 223.5) | 5.9 (6.6)                   | (1.5, 41.5) |  |  |
| <b>Staff Kitchen</b>         |             |              | <b>Staff Serving Area</b>   |             |  |  |
|                              | Mean (SD)   | (Min, Max)   | Mean (SD)                   | (Min, Max)  |  |  |
| 06:00 – 17:00                | 25.0 (29.9) | (1.5, 128.5) | 1.5 (0.4)                   | (1.5, 5.5)  |  |  |
| 09:00 – 22:00                | 20.3 (27.7) | (1.5, 180)   | 1.6 (0.8)                   | (1.5, 13.5) |  |  |

Mean = Arithmetic Mean CO (ppm) concentration within the defined time period

SD = standard deviation of the mean

(Min, Max) = the minimum and Maximum CO (ppm) concentrations within the defined time period

**Figures**



Figure 1: Outside view of the staff and student canteen

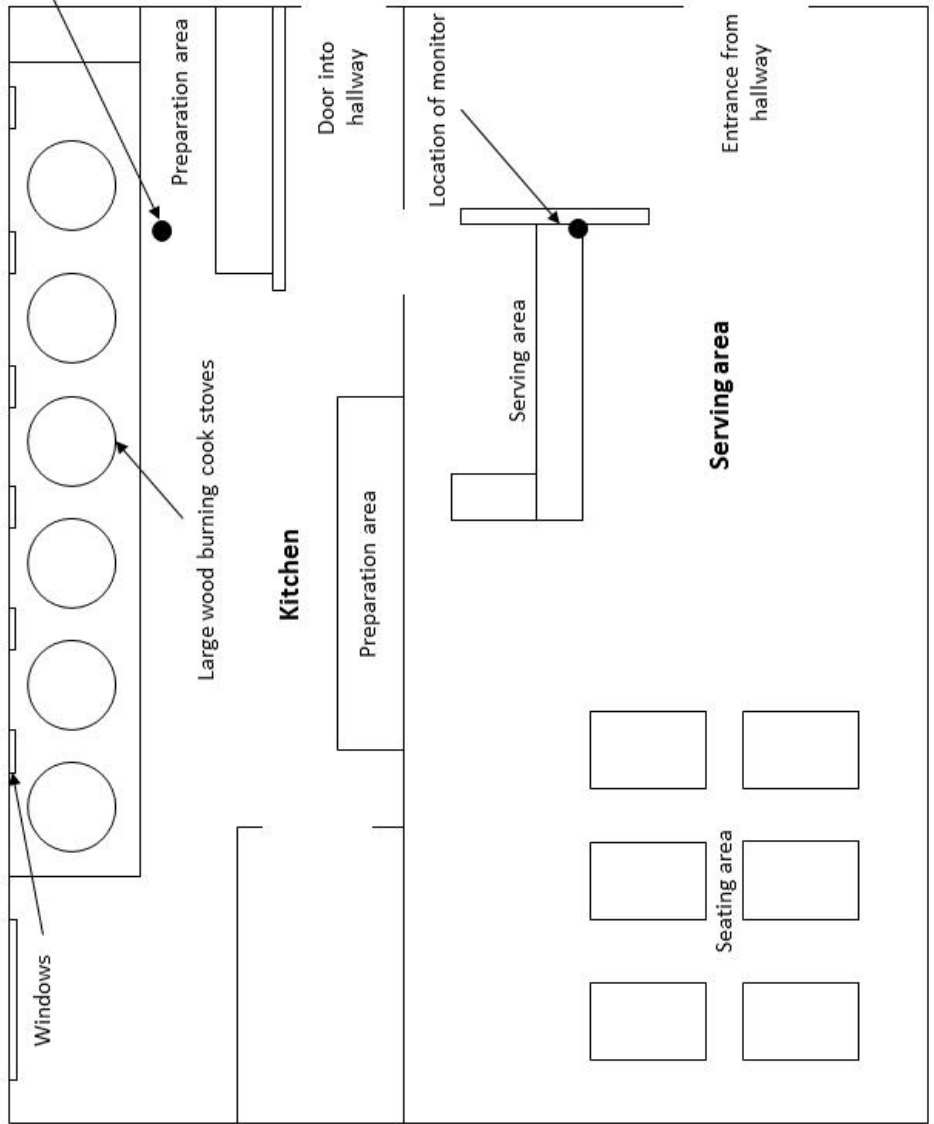

Location of monitor



Monitor suspended from ceiling 150 cm from the floor and 150 cm from the stove (Picture taken looking into the right-hand corner.



Monitor Attached to rail on serving desk. (Picture taken looking along the serving desk towards the seating area)

Not to Scale

Figure 2: Layout of student kitchen and serving area, with position of monitors

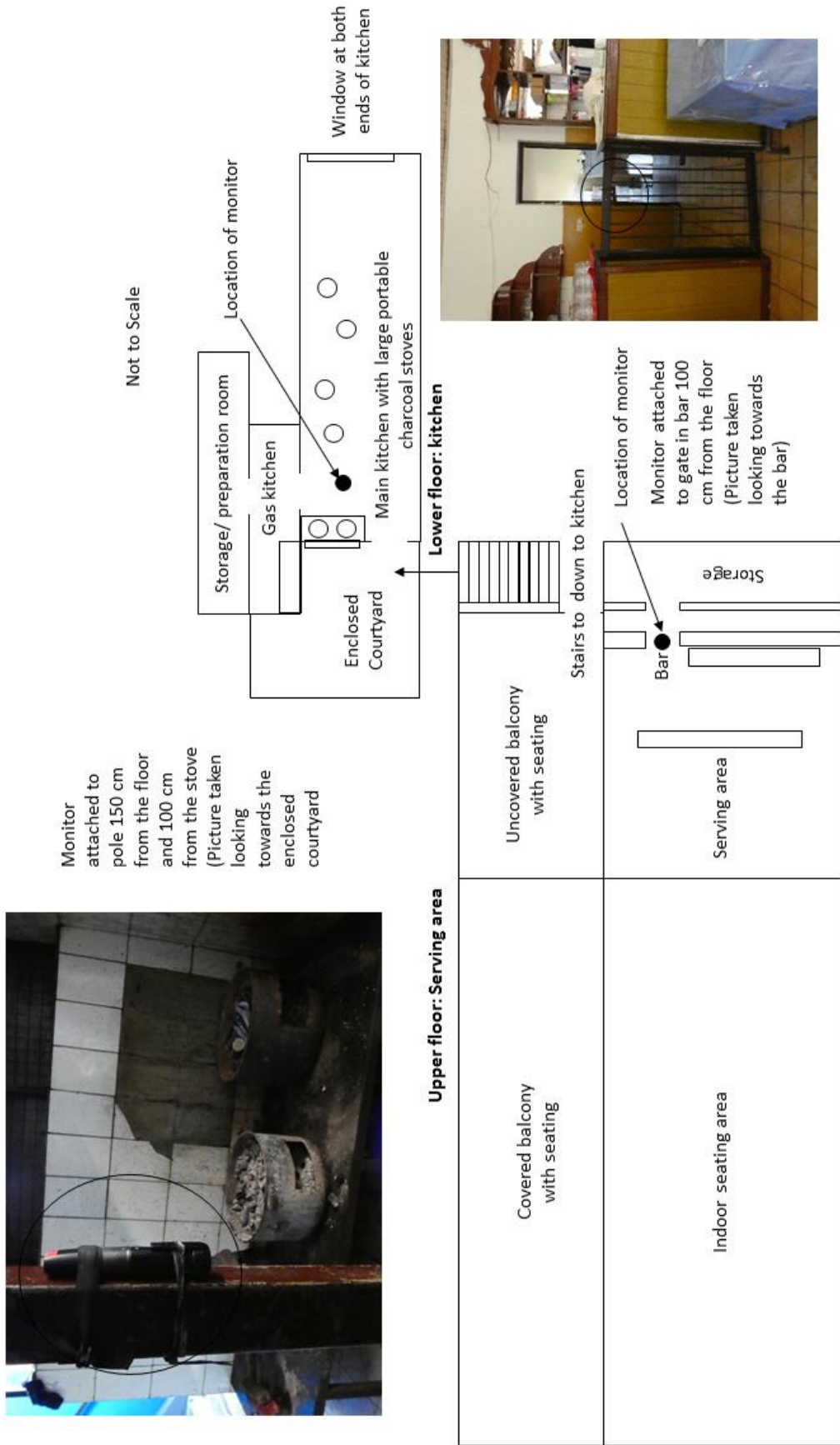

Figure 3: Layout of staff kitchen and Serving area, with position of monitors

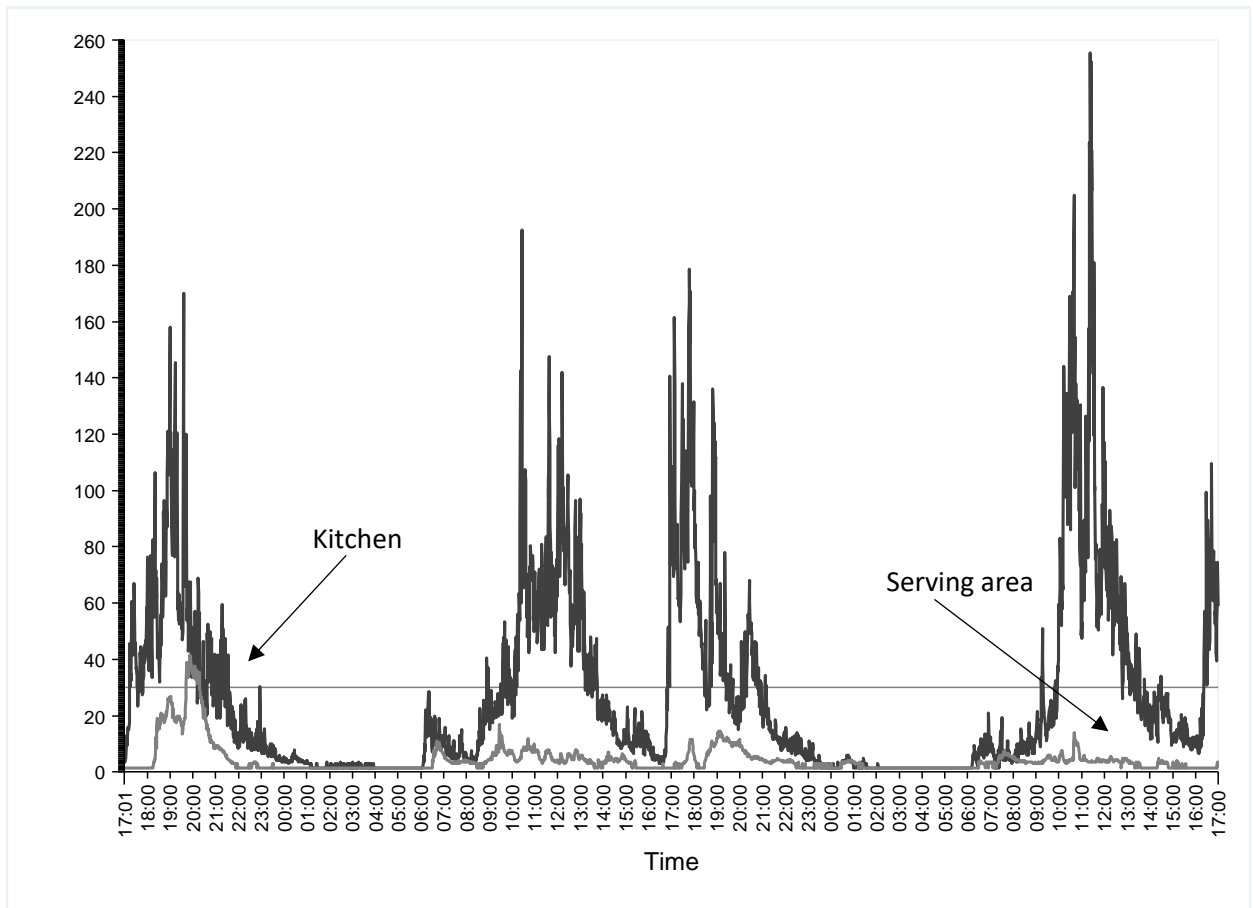

Figure 4: Variation in 1-minute CO concentrations (ppm) levels across 48 hours (Wednesday–Friday) within the student kitchen (Black line) and student serving area (Grey line) showing two diurnal cooking peaks in 12 hours. Reference denotes the UK occupational standard of 30 ppm.

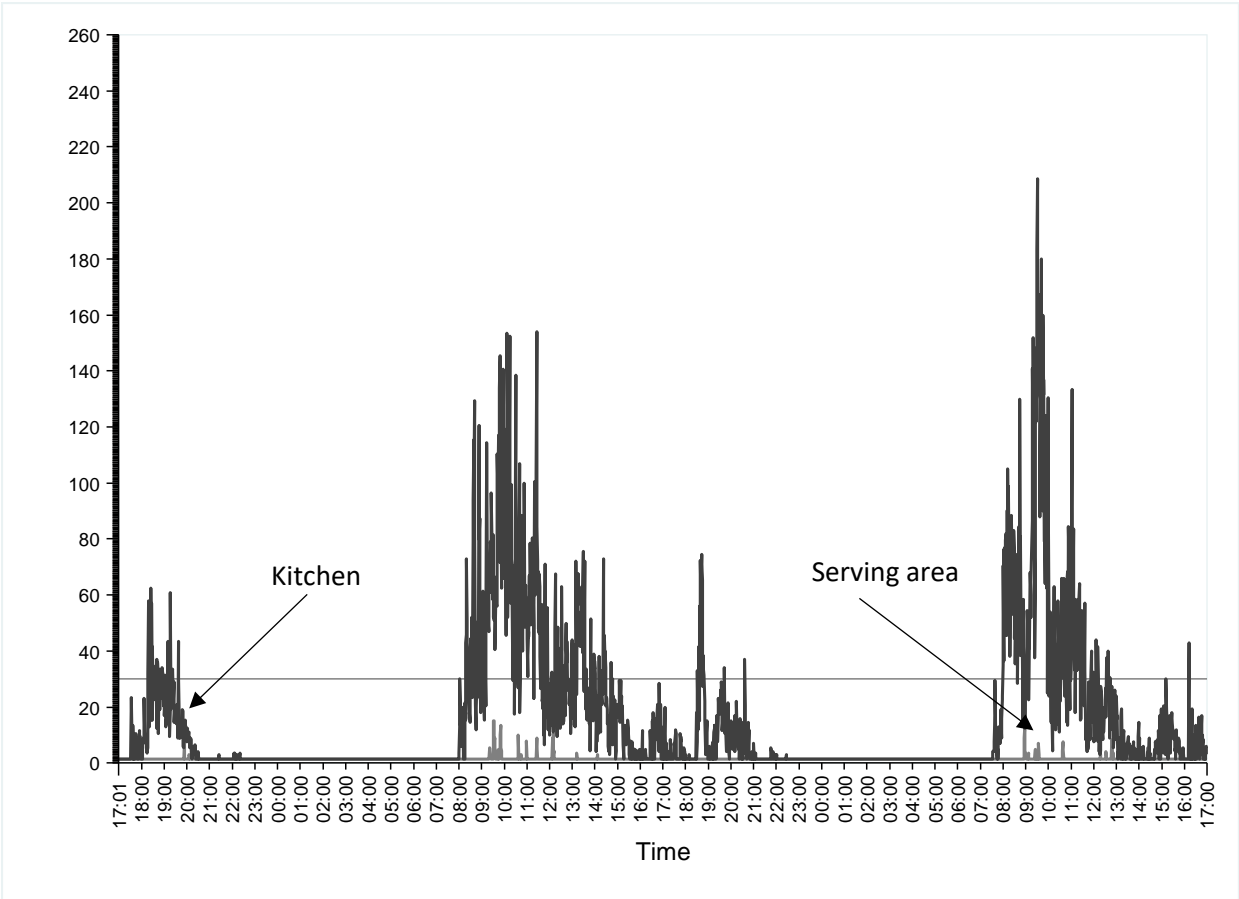

Figure 5: Variation in 1-minute CO concentrations (ppm) across 48 hours in the staff kitchen (Black line) and staff serving area (Grey line) showing two cooking phases in 12 hours. Reference line denotes the UK occupational standard of 30 ppm.

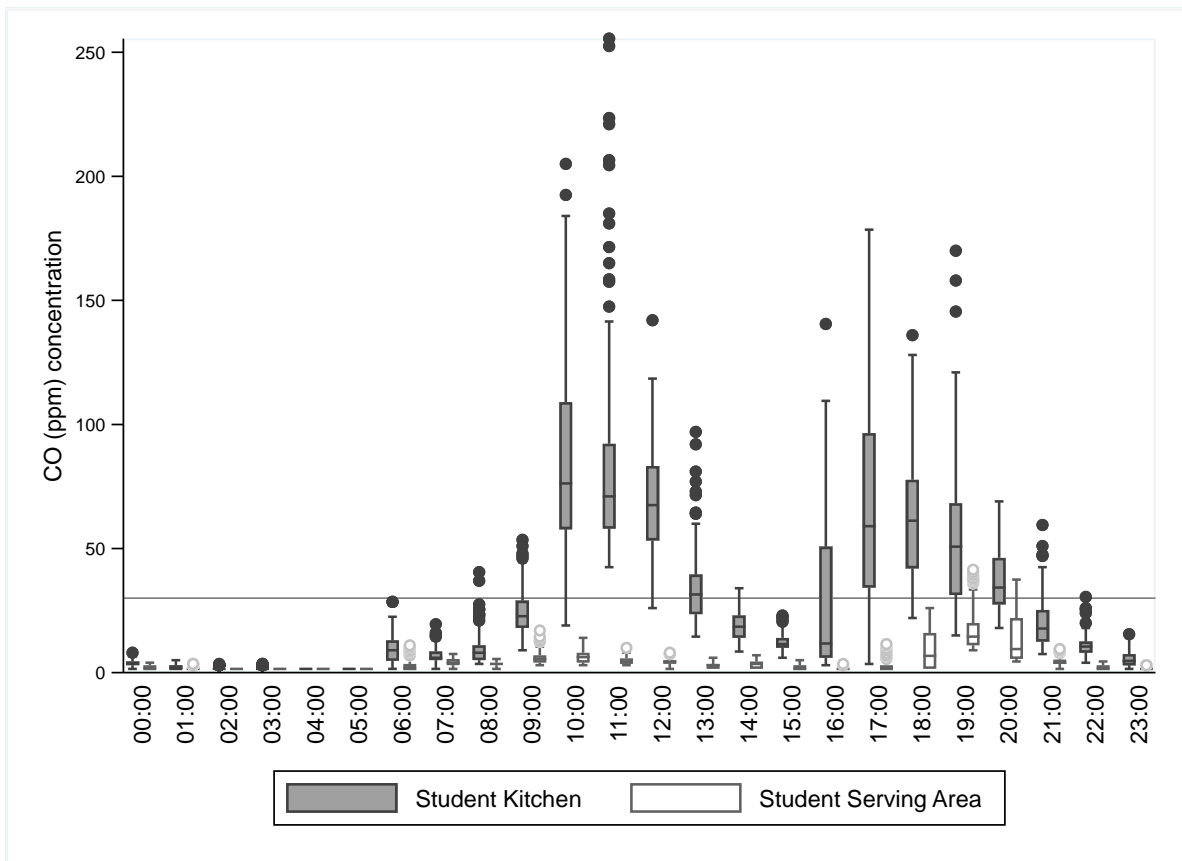

Figure 6: A box plot illustrating the average (median) hourly concentration of CO concentrations (ppm) in the student serving area by daytime working hour (06:00–22:00). Boxes represent the interquartile range, with the middle line indicating the median. Outliers are illustrated with points. 30 ppm reference line denotes UK occupational standard. (Numerical tables in Appendix 1)



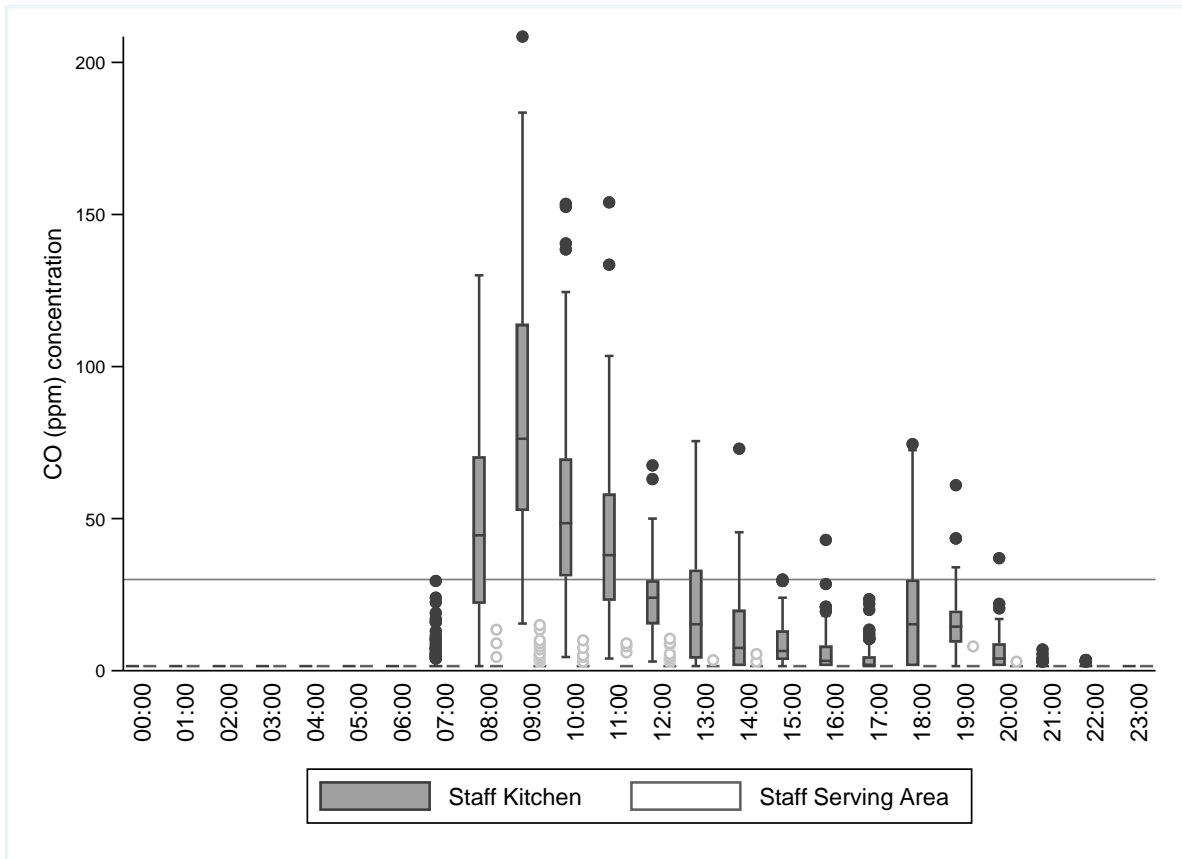

Figure 7: A box plot illustrating the average (median) hourly concentration of CO concentrations (ppm) in the staff serving area by working hour of the day (06:00–22:00). Boxes represent the interquartile range, with the middle line indicating the median. Outliers are illustrated with points. 30 ppm reference line denotes UK occupational standard. (Numerical tables in Appendix 2)